



Performing Moisture Analysis

After configuring all of the necessary parameters and preparing the sample, you may begin your moisture analysis by following the steps below:

1. Open the Drying Chamber.
2. Using the Pan Handle, place the Disposable Pan on the Pan Support.

Note: Be sure the Pan Handle is not touching the Pan Shield.



3. Press the T key to Tare the Disposable Pan.
4. Place the sample on the Disposable Pan. After the Tare has been performed, the Disposable Pan can be removed from the Pan Support by using the Pan Handle to evenly distribute the sample.

Note: Make sure the sample is evenly distributed on the Disposable Pan.

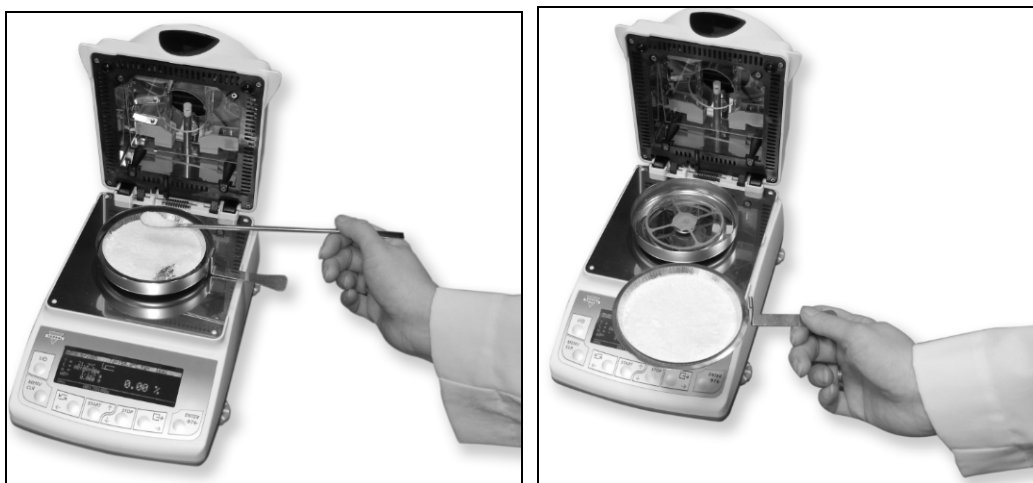



5. Close the Drying Chamber.
6. Press the START key. The unit will indicate on the display that Heating is in progress. The moisture content of the sample will be displayed as a percentage (%). During the analysis, in addition to the result, the display will indicate the Drying Chamber Temperature, the present weight of the sample, the elapsed time, and the initial weight of the sample.

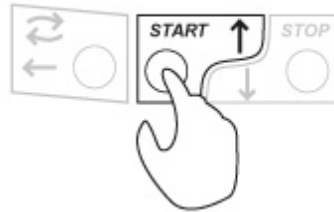

Important Caution Note: Do not touch the top surfaces of the Moisture Analyzer's Drying Chamber or any internal parts either during or soon after use. As the parts and surfaces will be very HOT, allow adequate time for the unit to cool. Be sure to read and follow all Caution Procedures listed in Chapter 1.

7. When the analysis is finished, "END" will be displayed in the lower right corner of the LCD. The Final result will remain displayed. To clear the result and prepare the unit for the next analysis, press the key STOP.

Important Note: Always use the forceps supplied with the unit when handling a used Disposable Pan.